

LIST "STANDARD K.D." SIX TIER LOCKER (9" TO 15' WIDE) (PRODUCT No. SK _____ -6_)

ELEVATION ' / ' /

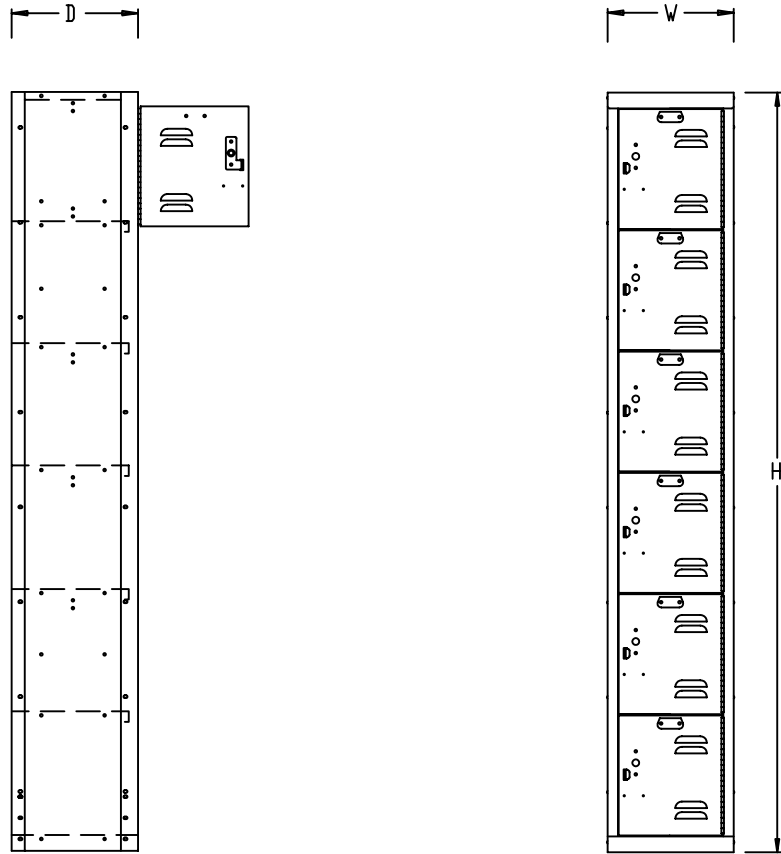

SIDE VIEW

FRONT VIEW

LOCKER DETAILS:

- DOOR & FRAME COLOR =
- BODY COMPONENT COLOR = 729 PARCHMENT
- TOP =
- HANDLE = FRICTION CATCH FINGER PULL
- DOOR VENTILATION = 3" LOUVERS
- SIDE VENTILATION = SOLID
- BASE =
- LOCKS =
- HINGE = CONTINUOUS PIANO HINGE

CONTRACTOR NOTE

ALL CONCRETE BASES SHOULD BE LEVEL AND TROWELED SMOOTH TO ASSURE PROPER INSTALLATION OF THE LOCKERS. ALL FLOORING MATERIAL ATTACHED TO THE FACE OF THE BASE SHOULD BE RECESSED AT LEAST 1/4" FROM THE TOP EDGE OF THE BASE. LOCKERS MUST BE ANCHORED TO WALL.

GAUGES

- DOOR = 18 GA., C.R.S.
- FRAME = 16 GA., C.R.S.
- TOP = 24 GA., C.R.S.
- BOTTOM = 24 GA., C.R.S.
- SHELVES = 24 GA., C.R.S.
- SIDES = 24 GA., C.R.S.
- BACKS = 24 GA., C.R.S.

LATCHING: (BOX DOOR) SINGLE POINT FRICTION CATCH WITH DOOR PULL. DOOR WILL ACCEPT BUILT-IN LOCK OR PADLOCK.

SUPERIOR

THIS DRAWING AND THE INFORMATION ON IT IS THE CONFIDENTIAL PROPERTY OF LIST INDUSTRIES, INC. AND SHALL NOT BE COPIED OR DISCLOSED TO OTHERS WITHOUT WRITTEN PERMISSION. ONLY LIST INDUSTRIES RESERVES THE RIGHT TO ALTER ANY DESIGN. ANY UNAUTHORIZED MODIFICATIONS RELEASES LIST INDUSTRIES FROM ALL LIABILITIES.

TOLERANCES UNLESS SPECIFIED:
 FRACTIONS: ±1/32 DECIMALS: ±.010 DEGREES: ±1°

Customer: CUSTOMER

Customer Order Number: PO#

Description:

JOB NAME
 JOB LOCATION

Drawn By:
 DRAFTER

Checked By:

Date: DATE

Scale: NONE

Acad Number: PAGE NUMBER

Sheet # Of #

Revision:

Drawing Number: FOLDER NUMBER